

# Canon Pop-up Card (Chinese New Year) : Assembly Instructions

Canon® is a registered trademark of Canon Inc. © HIROKO



<http://www.canon.com/c-park/en/>



## Assembly Instructions

..... **Mountain fold**(dotted line) ——— **Scissors line**(solid line)  
\*Make a mountain fold. \*Cut along the line.

- - - - - **Valley fold**  
(dashed and dotted line)  
\*Make a valley fold.

▲ **Black triangle**  
Glue here

△ **White triangle**  
Glue the back



**You will need**

scissors, paste, a used ballpoint pen (tracing along the fold lines makes them easier to fold)



**Caution:** Glue, scissors, and other tools may be dangerous to young children so be sure to keep them out of the reach of young children.

**1** Cut out the parts and crease them along the fold lines indicated.

● Part A



● Part C



● Stickers



● Part B



● Part D



● Supports



● Part E



● Butterfly (Left)

● Butterfly (Right)

● Front cover



● Back cover



● Base



**2** Slot parts A and B together.



# Canon Pop-up Card (Chinese New Year) : Assembly Instructions

Canon® is a registered trademark of Canon Inc. © HIROKO

**3** Slot parts C and D together, as you did in step 2.

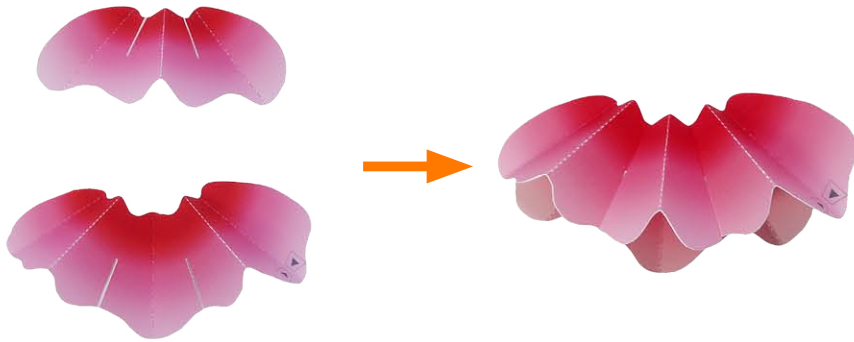

**4** Attach supports to the glue spots on the parts made in step 3.

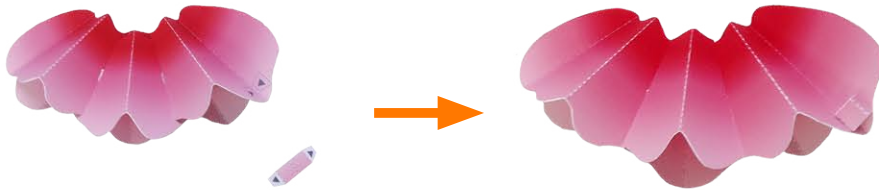

**5** Put the two halves of the butterfly together, joining them at the slots shown in red.

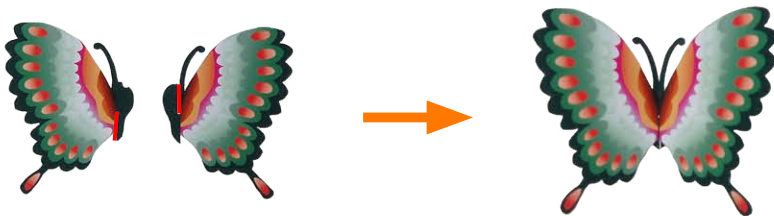

**6** Paste the parts from step 5 to the supports from step 4.

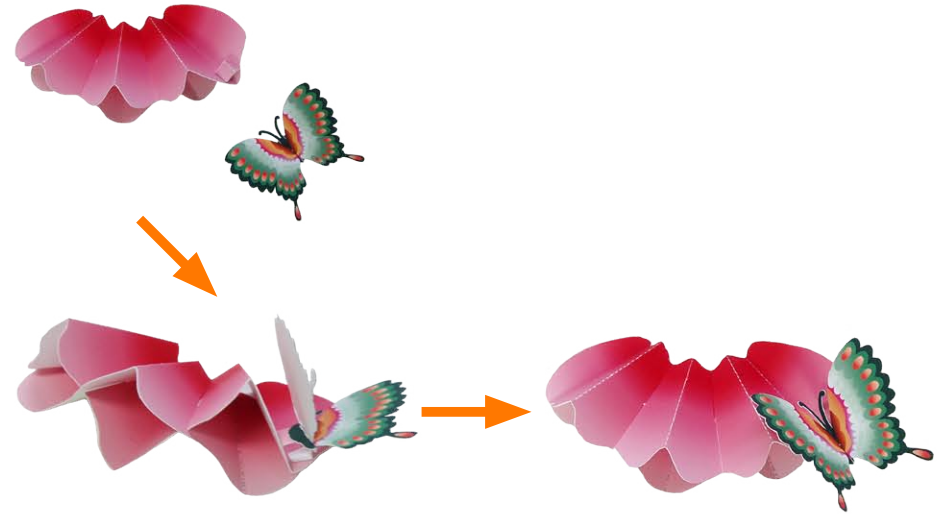

**7** Paste parts E, one at a time, to the base.

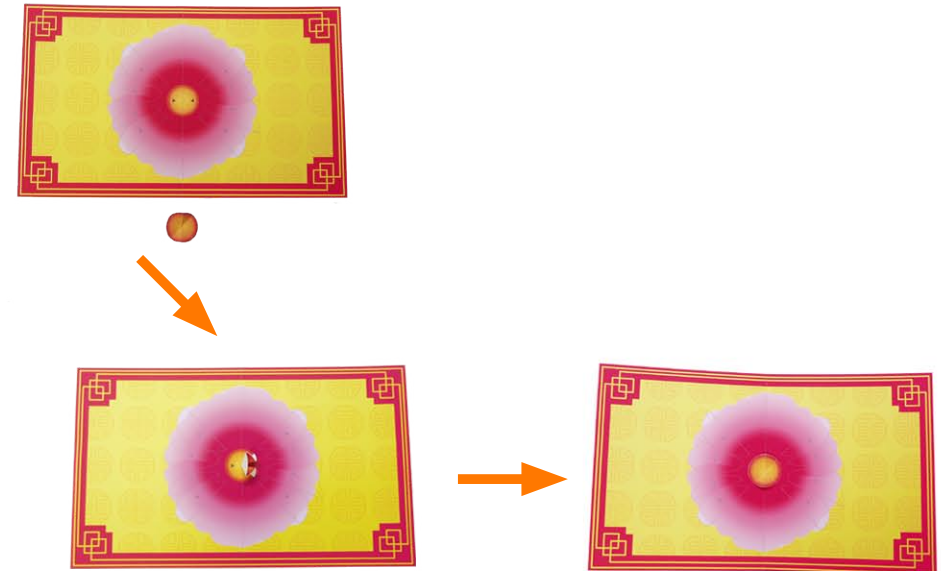

# Canon Pop-up Card (Chinese New Year) : Assembly Instructions

Canon® is a registered trademark of Canon Inc. © HIROKO

**8** Take each part made in step 2 and glue it to the base, starting from the center.

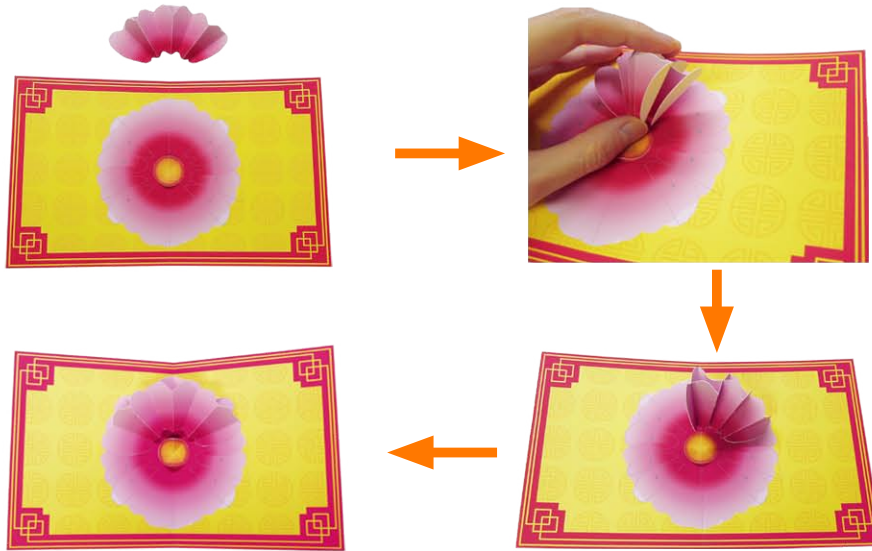

**9** Take each part made in step 6 and glue it to the base, starting from the center.

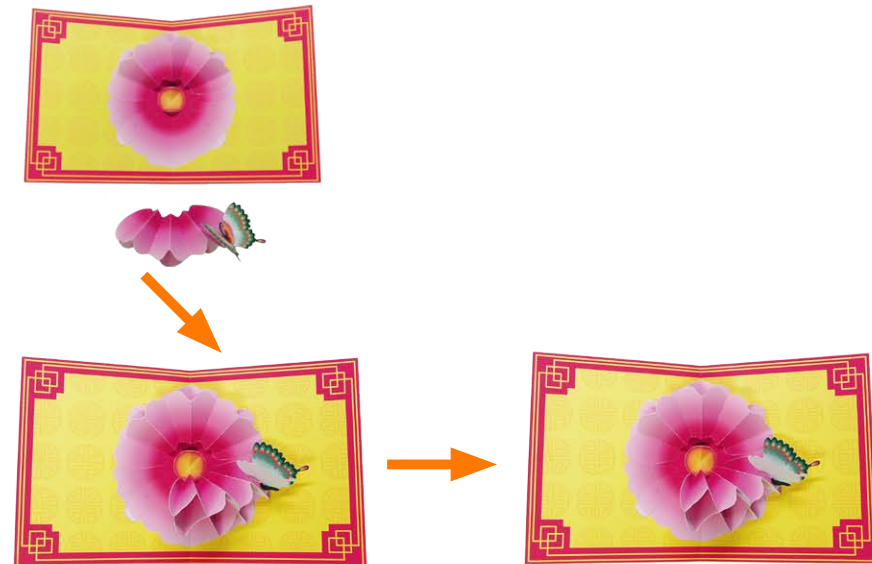

**10** Decorate with stickers as you like.



**11** Paste the front cover onto the back of the left hand side of the base.

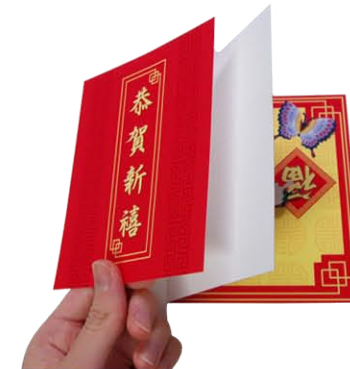

**12** Finally, paste the back cover onto the back of the right hand side of the base.

